

Channels SZ-W1,25 28X18

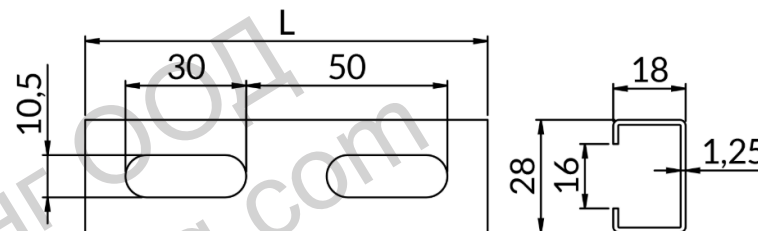

● **Corrosion protection:** galvanic zinc coating

● **Application:** universal mounting profile system for building fastening systems

Dimensions L [mm]	Unit weight [kg]	Order designation	Catalog number
2000	1.28	SZ-W1,25-2000	80728181220
3000	1.92	SZ-W1,25-3000	80728181230
4000	2.56	SZ-W1,25-4000	80728181240
6000	3.84	SZ-W1,25-6000	80728181260

Approvals EN-ITB-KOT-2020_1562 wydanie 1 > Declarations EN-KDWU 05_2020